

Sold

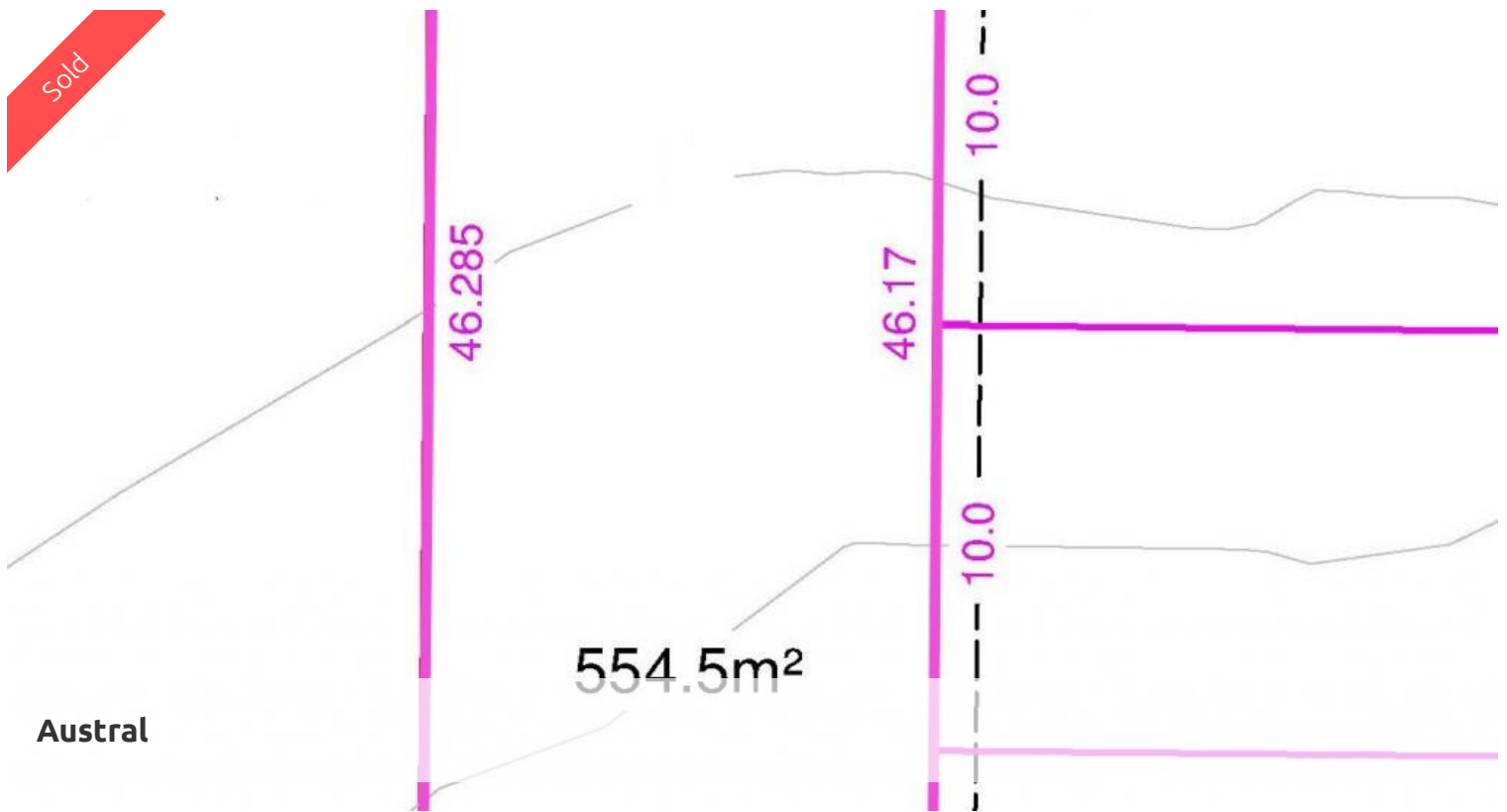

GET READY TO BUILD SOON

Get in quick to secure your perfect 554m² block in Austral. Expected registration soon approx. Mid Sept 2021.

This block is just a short drive to Leppington Train Station and local schools.

Located;

- Walking distance to the local shops, doctors, pharmacy, cafes and restaurants.
- 3km from the M7
- 4km from Carnes Hill Shopping and Recreation Centres
- 9km from the Liverpool CBD
- No developer restrictions.
- 400 metres from the Western Sydney Parklands track (suitable for walking, jogging and cycling).

Book in an inspection time now with Wos Ayoubi on 0425 234 980.

The above information provided has been furnished to us by the vendor/s. We have not verified whether or not that information is accurate and do not have any belief in one way or the other in its accuracy. We do not accept any responsibility to any person for its accuracy and do no more than pass it on. All interested parties should make and rely upon their own inquiries in order to determine whether or not this information is in fact accurate.

Price	SOLD
Property Type	residential
Property ID	382
Land Area	554 m ²

Agent Details

Wos Ayoubi - 0425 234 980

Office Details

Leppington
0425 234 980

WOSREALTY